

## PART 1- 2 STEP

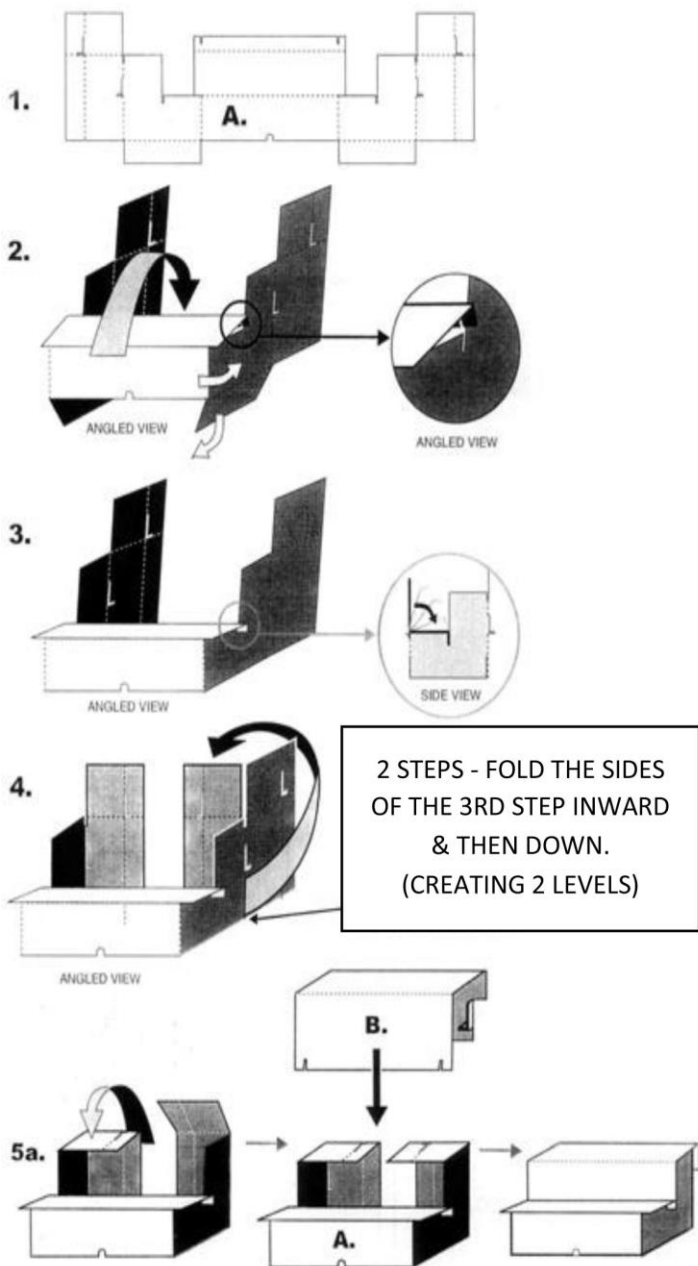

## PART 2- 3 STEP

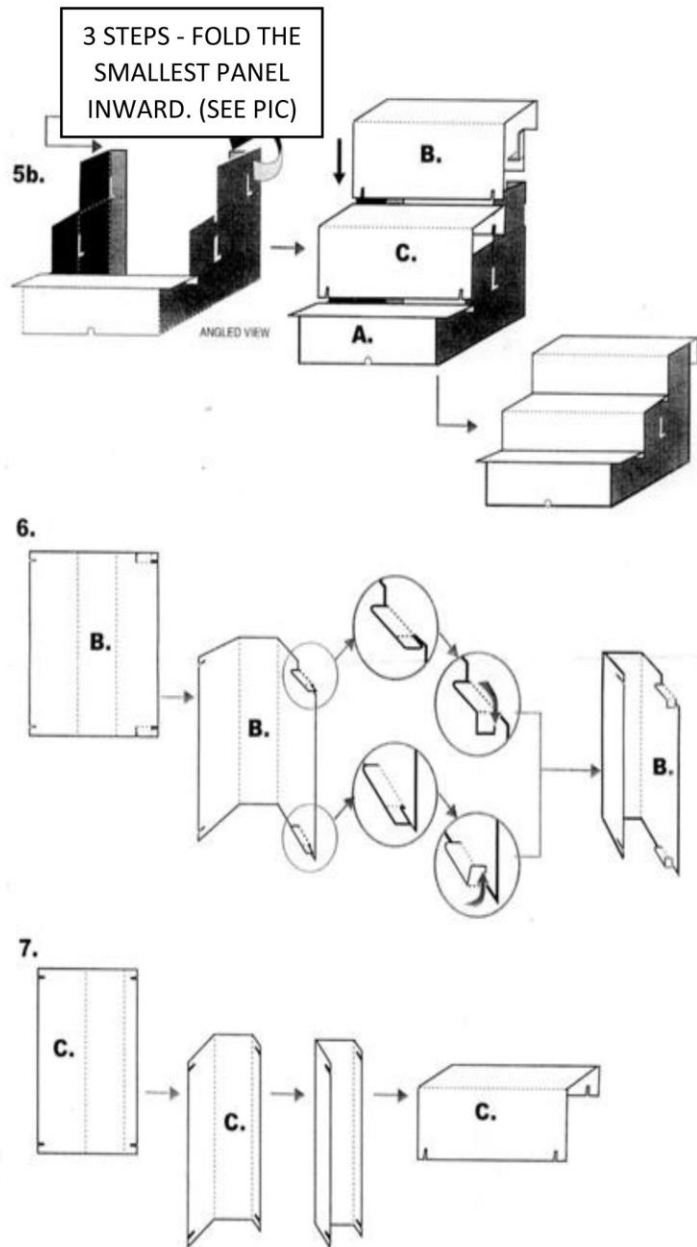

### HELPFUL TIPS

- Fold along creases that are already in cardboard.
- The panel with Gershel Brothers information is the back of Part B.
- Parts B. & C. are attached and should be separated along perforation.
- When making a 2-step riser, you will not use Part C.
- When making a 3-step riser, Part C. is the middle step.
- The tabs on the back of Part B insert into the L-Shaped slots on the back of Part A.