

ASSEMBLY INSTRUCTIONS

PW/SW100

**NOTE: ASSEMBLY
OF THIS UNIT REQUIRES
(2) PEOPLE**

PARTS LIST:

- (1) BASE W/ CASTERS
- (2) 1-SIDED SLATWALL END PANELS
- (2) 2 SIDED SLATWALL CENTER PANELS
- (2) 3" THREADED SWEDGE FITTINGS
- (3) 1/4-20 THREADED RODS 49-1/8"L
- (6) 1/4-20 CAP NUTS
- (6) DOWELS 8MM x 30MM
- (1) ALLEN KEY

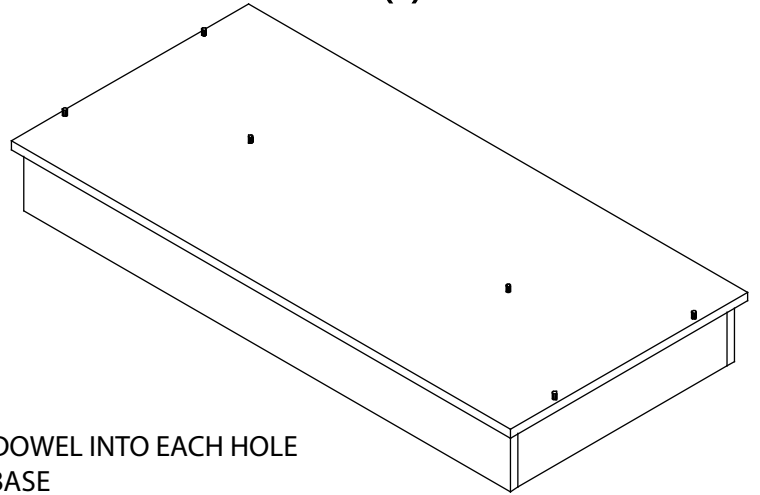

1. INSERT (1) DOWEL INTO EACH HOLE
IN TOP OF BASE

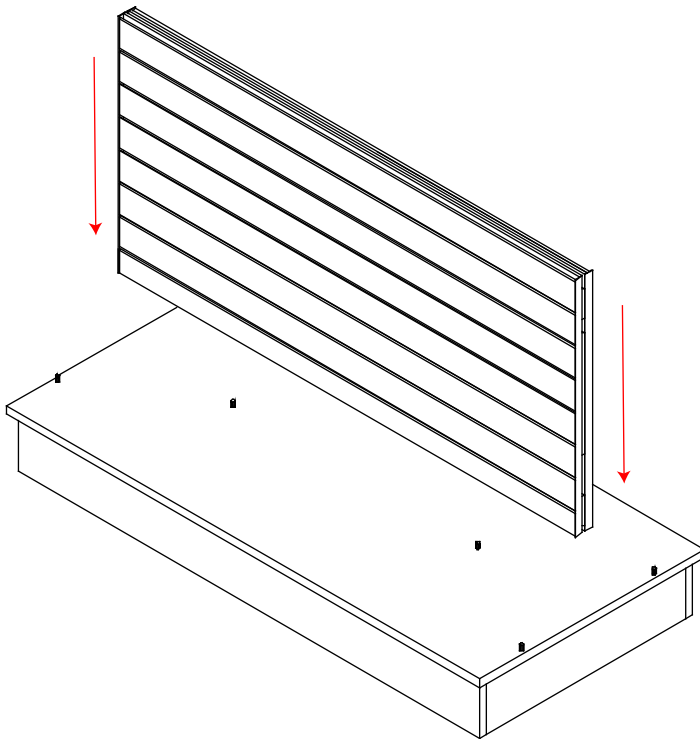

2. PLACE THE BOTTOM CENTER PANEL (THE ONE WITHOUT
THE (2) HOLES IN THE TOP) ON THE BASE. THE SLOT IN THE
BOTTOM OF THE PANEL WILL LINE UP WITH THE DOWELS
IN THE CENTER OF THE BASE.

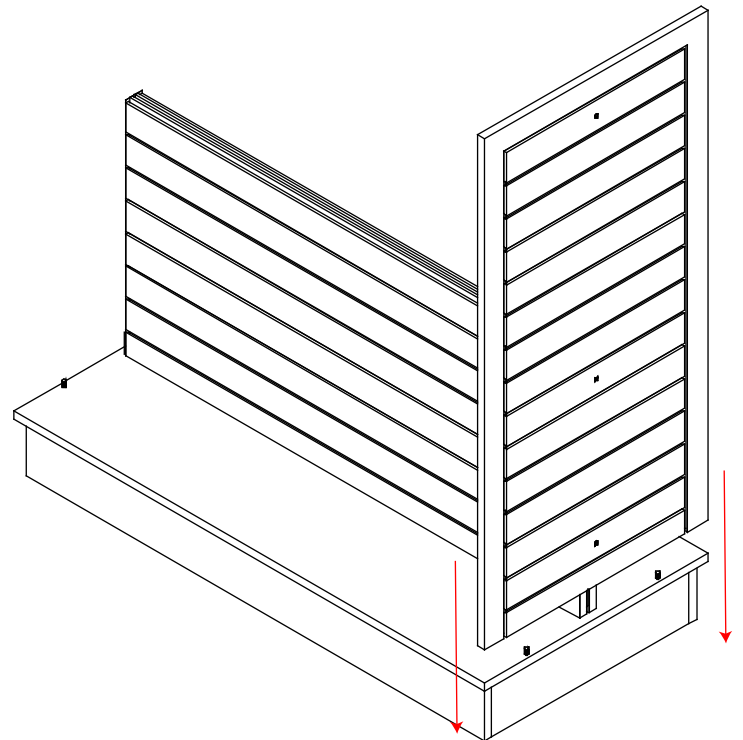

3. PLACE ONE OF THE END PANELS ON THE END
(SLATWALL OUT) THE DOWELS IN THE BASE WILL
LINE UP WITH THE HOLES IN THE BOTTOM OF
THE END PANEL.

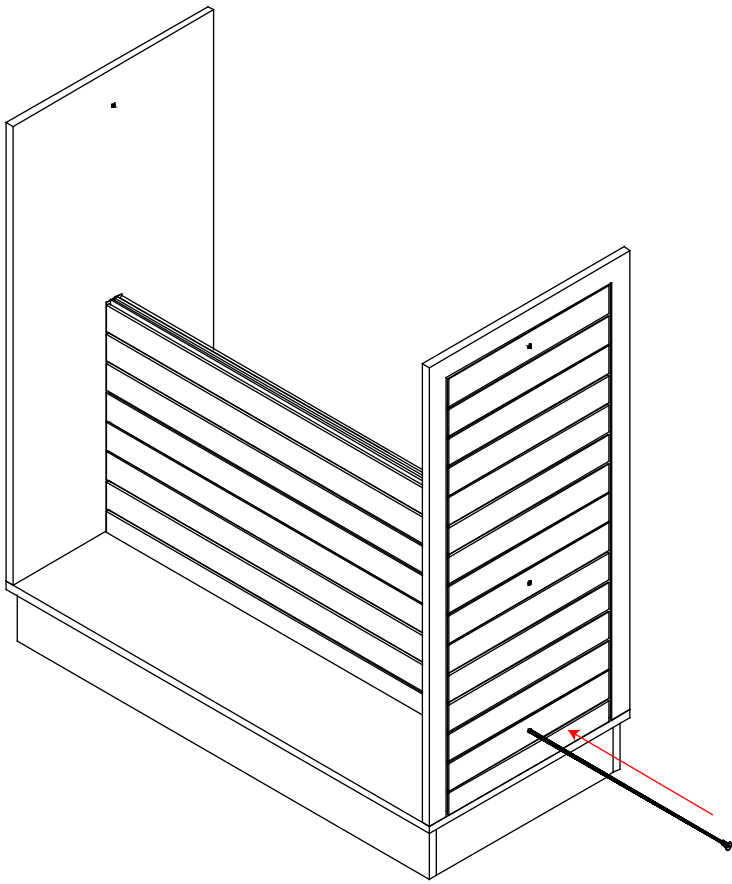

* ON THE OPPOSITE SIDE YOU WILL NEED TO TILT THE END PANEL SLIGHTLY AND USE THE ALLEN KEY TO GUIDE THE THREADED ROD INTO THE HOLE.

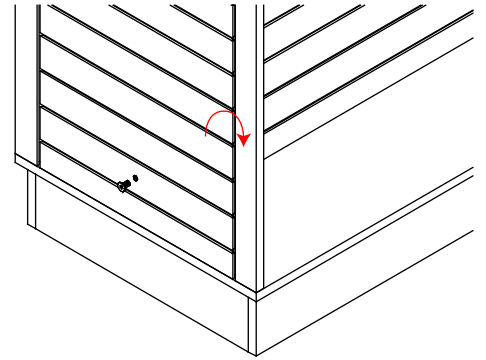

4. REPEAT STEP 3 ON THE OTHER SIDE, REMOVE THE CAP NUT FROM ONE END OF THE THREADED ROD AND FEED IT THROUGH THE BOTTOM HOLE IN THE END PANEL AND ACROSS TO THE OTHER SIDE.

*USE THE ALLEN KEY TO TIGHTEN THE CAP NUT

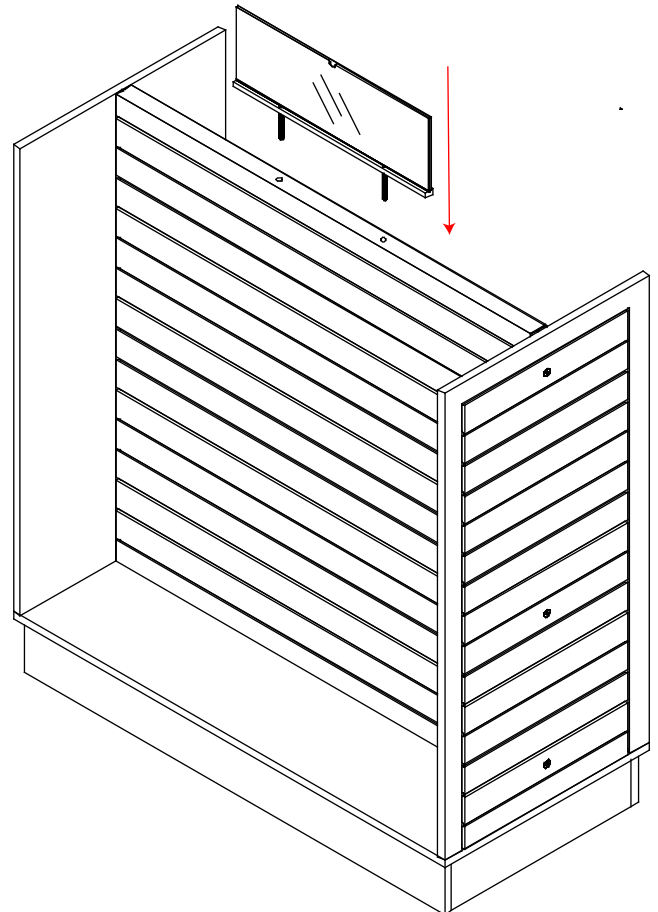
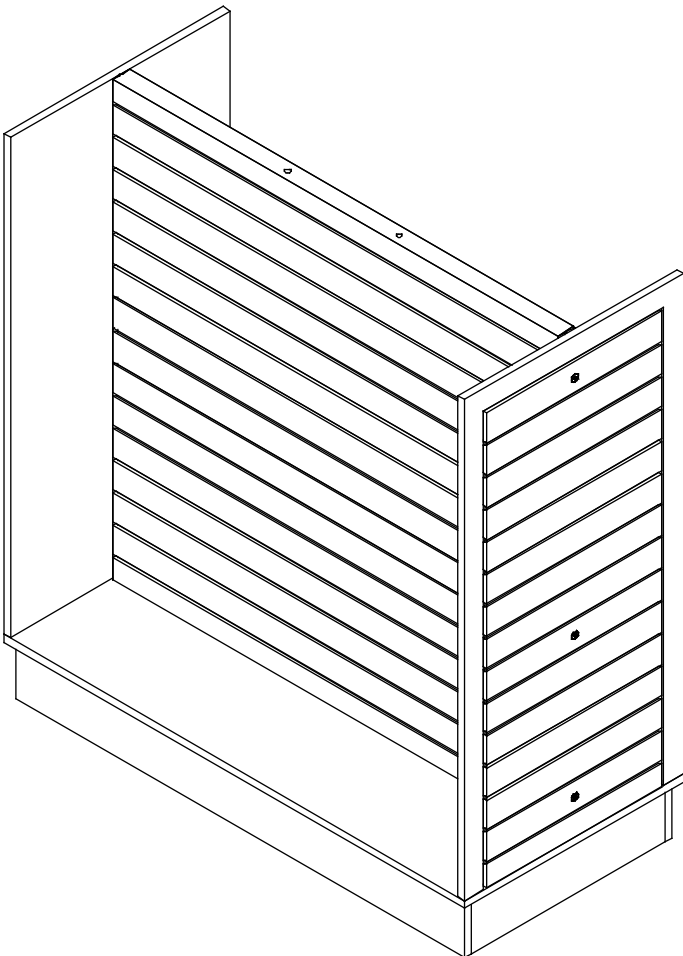

5. REPEAT STEP 4 WITH THE OTHER 2 THREADED RODS.

6. ATTACH THE (2) THREADED SWEDGE STEMS TO THE 22-1/2" x 4-1/2" SIGN HOLDER, AND PLACE IT INTO THE (2) HOLES IN THE TOP OF THE UPPER CENTER PANEL.

